

- U-1 DWELLING-SINGLE AND TWO FAMILY
- U-2 APARTMENT
- U-3 RETAIL
- U-4 COMMERCIAL-PUBLIC GAZETTE AND LIGHT W/FC
- U-5 INDUSTRIAL
- U-6 LIMITED RESIDENCE-BUSINESS USE DISTRICT-ORD. NO. 5447 PASSED APR. 21, 1964.

- A-1 4000 SQ. FT. PER FAMILY-2800 SQ. FT. ON CORNERS
- A-2 2000 SQ. FT. PER FAMILY-1600 SQ. FT. ON CORNERS
- A-3 LESS THAN 2000 SQ. FT. PER FAMILY-1000 SQ. FT. ON CORNERS
- H-1 30 FT HIGH
- H-2 30 FT HIGH
- H-3 30 FT HIGH
- H-4 100 FT HIGH
- H-5 125 FT HIGH-ORD. NO. 3145 PASSED DEC. 2, 1948
- H-6 150 FT HIGH-ORD. NO. 3346 PASSED OCT. 3, 1961
- H-7 175 FT HIGH-ORD. NO. 3346 PASSED OCT. 3, 1961
- H-8 200 FT HIGH-ORD. NO. 3347 PASSED MAY 9, 1962
- H-9 225 FT HIGH-ORD. NO. 3347 PASSED MAY 9, 1962
- H-10 250 FT HIGH-ORD. NO. 6038 PASSED JAN. 23, 1970

- B-1 BUILDING LINE DETERMINED BY ALIGNMENT OF EXISTING BUILDINGS
- B-2 BUILDING LINE AS SHOWN

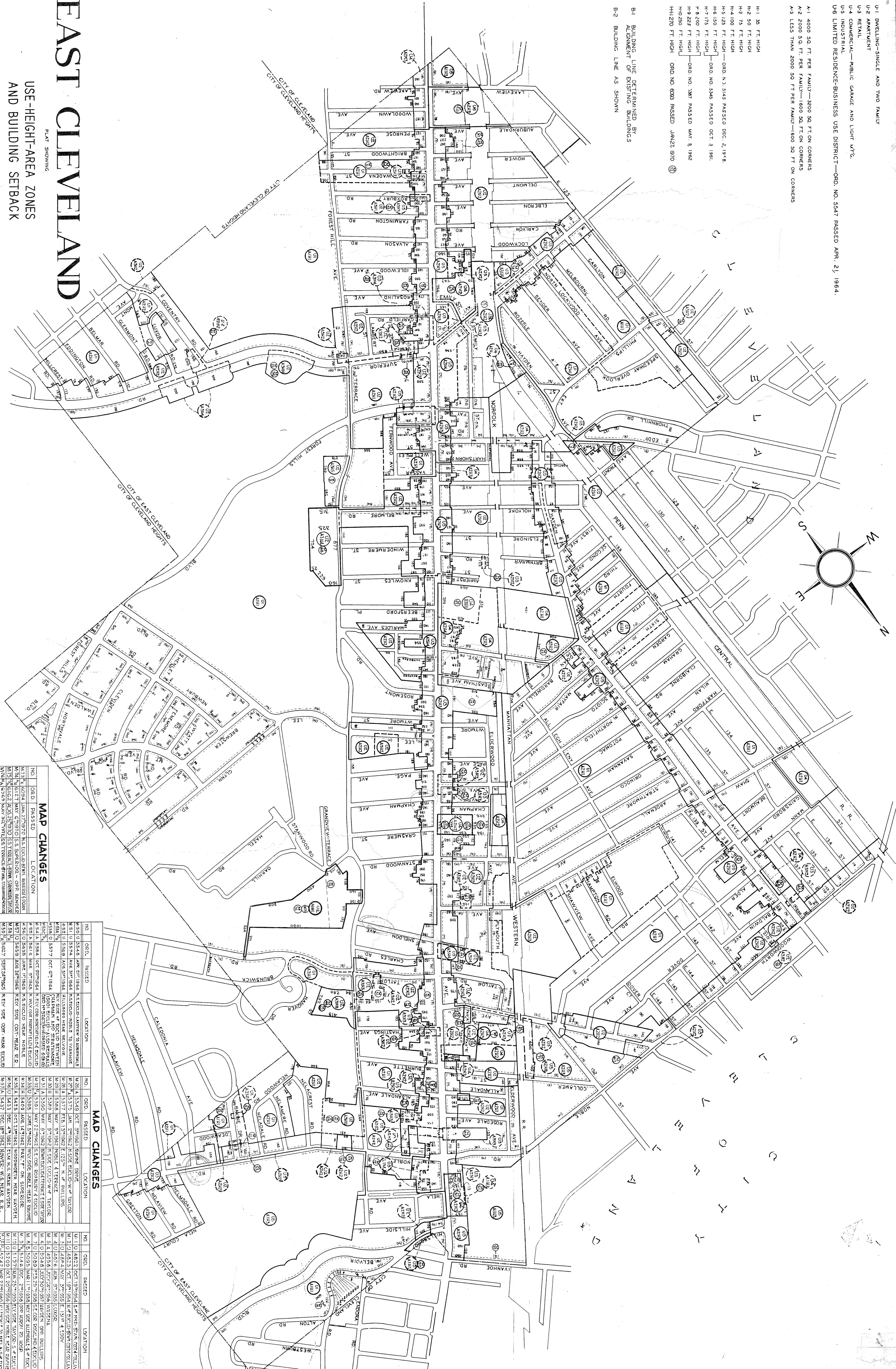

EAST CLEVELAND

PLAT SHOWING
USE-HEIGHT-AREA ZONES
AND BUILDING SETBACK

ORDINANCE NO. 4761-NOVEMBER 17
1953

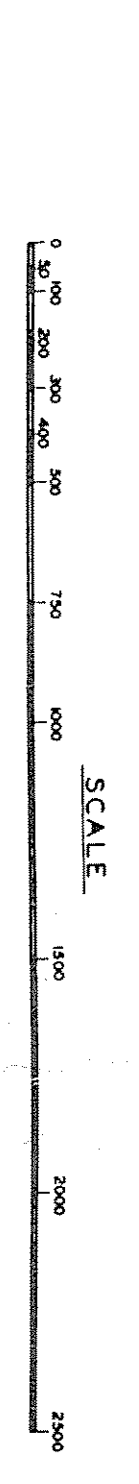

Note: This drawing is a reproduction made in April, 1984 from a record drawing.

MAP CHANGES

NO.	ORD.	PASSED	LOCATION
M-10	1534	OCT. 1954	1000 W. 15TH ST. TO 1000 W. 16TH ST.
M-11	1535	OCT. 1954	1000 W. 16TH ST. TO 1000 W. 17TH ST.
M-12	1536	OCT. 1954	1000 W. 17TH ST. TO 1000 W. 18TH ST.
M-13	1537	OCT. 1954	1000 W. 18TH ST. TO 1000 W. 19TH ST.
M-14	1538	OCT. 1954	1000 W. 19TH ST. TO 1000 W. 20TH ST.
M-15	1539	OCT. 1954	1000 W. 20TH ST. TO 1000 W. 21ST ST.
M-16	1540	OCT. 1954	1000 W. 21ST ST. TO 1000 W. 22ND ST.
M-17	1541	OCT. 1954	1000 W. 22ND ST. TO 1000 W. 23RD ST.
M-18	1542	OCT. 1954	1000 W. 23RD ST. TO 1000 W. 24TH ST.
M-19	1543	OCT. 1954	1000 W. 24TH ST. TO 1000 W. 25TH ST.
M-20	1544	OCT. 1954	1000 W. 25TH ST. TO 1000 W. 26TH ST.
M-21	1545	OCT. 1954	1000 W. 26TH ST. TO 1000 W. 27TH ST.
M-22	1546	OCT. 1954	1000 W. 27TH ST. TO 1000 W. 28TH ST.
M-23	1547	OCT. 1954	1000 W. 28TH ST. TO 1000 W. 29TH ST.
M-24	1548	OCT. 1954	1000 W. 29TH ST. TO 1000 W. 30TH ST.
M-25	1549	OCT. 1954	1000 W. 30TH ST. TO 1000 W. 31ST ST.
M-26	1550	OCT. 1954	1000 W. 31ST ST. TO 1000 W. 32ND ST.
M-27	1551	OCT. 1954	1000 W. 32ND ST. TO 1000 W. 33RD ST.
M-28	1552	OCT. 1954	1000 W. 33RD ST. TO 1000 W. 34TH ST.
M-29	1553	OCT. 1954	1000 W. 34TH ST. TO 1000 W. 35TH ST.
M-30	1554	OCT. 1954	1000 W. 35TH ST. TO 1000 W. 36TH ST.
M-31	1555	OCT. 1954	1000 W. 36TH ST. TO 1000 W. 37TH ST.
M-32	1556	OCT. 1954	1000 W. 37TH ST. TO 1000 W. 38TH ST.
M-33	1557	OCT. 1954	1000 W. 38TH ST. TO 1000 W. 39TH ST.
M-34	1558	OCT. 1954	1000 W. 39TH ST. TO 1000 W. 40TH ST.
M-35	1559	OCT. 1954	1000 W. 40TH ST. TO 1000 W. 41ST ST.
M-36	1560	OCT. 1954	1000 W. 41ST ST. TO 1000 W. 42ND ST.
M-37	1561	OCT. 1954	1000 W. 42ND ST. TO 1000 W. 43RD ST.
M-38	1562	OCT. 1954	1000 W. 43RD ST. TO 1000 W. 44TH ST.
M-39	1563	OCT. 1954	1000 W. 44TH ST. TO 1000 W. 45TH ST.
M-40	1564	OCT. 1954	1000 W. 45TH ST. TO 1000 W. 46TH ST.
M-41	1565	OCT. 1954	1000 W. 46TH ST. TO 1000 W. 47TH ST.
M-42	1566	OCT. 1954	1000 W. 47TH ST. TO 1000 W. 48TH ST.
M-43	1567	OCT. 1954	1000 W. 48TH ST. TO 1000 W. 49TH ST.
M-44	1568	OCT. 1954	1000 W. 49TH ST. TO 1000 W. 50TH ST.
M-45	1569	OCT. 1954	1000 W. 50TH ST. TO 1000 W. 51ST ST.
M-46	1570	OCT. 1954	1000 W. 51ST ST. TO 1000 W. 52ND ST.
M-47	1571	OCT. 1954	1000 W. 52ND ST. TO 1000 W. 53RD ST.
M-48	1572	OCT. 1954	1000 W. 53RD ST. TO 1000 W. 54TH ST.
M-49	1573	OCT. 1954	1000 W. 54TH ST. TO 1000 W. 55TH ST.
M-50	1574	OCT. 1954	1000 W. 55TH ST. TO 1000 W. 56TH ST.
M-51	1575	OCT. 1954	1000 W. 56TH ST. TO 1000 W. 57TH ST.
M-52	1576	OCT. 1954	1000 W. 57TH ST. TO 1000 W. 58TH ST.
M-53	1577	OCT. 1954	1000 W. 58TH ST. TO 1000 W. 59TH ST.
M-54	1578	OCT. 1954	1000 W. 59TH ST. TO 1000 W. 60TH ST.
M-55	1579	OCT. 1954	1000 W. 60TH ST. TO 1000 W. 61ST ST.
M-56	1580	OCT. 1954	1000 W. 61ST ST. TO 1000 W. 62ND ST.
M-57	1581	OCT. 1954	1000 W. 62ND ST. TO 1000 W. 63RD ST.
M-58	1582	OCT. 1954	1000 W. 63RD ST. TO 1000 W. 64TH ST.
M-59	1583	OCT. 1954	1000 W. 64TH ST. TO 1000 W. 65TH ST.
M-60	1584	OCT. 1954	1000 W. 65TH ST. TO 1000 W. 66TH ST.
M-61	1585	OCT. 1954	1000 W. 66TH ST. TO 1000 W. 67TH ST.
M-62	1586	OCT. 1954	1000 W. 67TH ST. TO 1000 W. 68TH ST.
M-63	1587	OCT. 1954	1000 W. 68TH ST. TO 1000 W. 69TH ST.
M-64	1588	OCT. 1954	1000 W. 69TH ST. TO 1000 W. 70TH ST.
M-65	1589	OCT. 1954	1000 W. 70TH ST. TO 1000 W. 71ST ST.
M-66	1590	OCT. 1954	1000 W. 71ST ST. TO 1000 W. 72ND ST.
M-67	1591	OCT. 1954	1000 W. 72ND ST. TO 1000 W. 73RD ST.
M-68	1592	OCT. 1954	1000 W. 73RD ST. TO 1000 W. 74TH ST.
M-69	1593	OCT. 1954	1000 W. 74TH ST. TO 1000 W. 75TH ST.
M-70	1594	OCT. 1954	1000 W. 75TH ST. TO 1000 W. 76TH ST.
M-71	1595	OCT. 1954	1000 W. 76TH ST. TO 1000 W. 77TH ST.
M-72	1596	OCT. 1954	1000 W. 77TH ST. TO 1000 W. 78TH ST.
M-73	1597	OCT. 1954	1000 W. 78TH ST. TO 1000 W. 79TH ST.
M-74	1598	OCT. 1954	1000 W. 79TH ST. TO 1000 W. 80TH ST.
M-75	1599	OCT. 1954	1000 W. 80TH ST. TO 1000 W. 81ST ST.
M-76	1600	OCT. 1954	1000 W. 81ST ST. TO 1000 W. 82ND ST.
M-77	1601	OCT. 1954	1000 W. 82ND ST. TO 1000 W. 83RD ST.
M-78	1602	OCT. 1954	1000 W. 83RD ST. TO 1000 W. 84TH ST.
M-79	1603	OCT. 1954	1000 W. 84TH ST. TO 1000 W. 85TH ST.
M-80	1604	OCT. 1954	1000 W. 85TH ST. TO 1000 W. 86TH ST.
M-81	1605	OCT. 1954	1000 W. 86TH ST. TO 1000 W. 87TH ST.
M-82	1606	OCT. 1954	1000 W. 87TH ST. TO 1000 W. 88TH ST.
M-83	1607	OCT. 1954	1000 W. 88TH ST. TO 1000 W. 89TH ST.
M-84	1608	OCT. 1954	1000 W. 89TH ST. TO 1000 W. 90TH ST.
M-85	1609	OCT. 1954	1000 W. 90TH ST. TO 1000 W. 91ST ST.
M-86	1610	OCT. 1954	1000 W. 91ST ST. TO 1000 W. 92ND ST.
M-87	1611	OCT. 1954	1000 W. 92ND ST. TO 1000 W. 93RD ST.
M-88	1612	OCT. 1954	1000 W. 93RD ST. TO 1000 W. 94TH ST.
M-89	1613	OCT. 1954	1000 W. 94TH ST. TO 1000 W. 95TH ST.
M-90	1614	OCT. 1954	1000 W. 95TH ST. TO 1000 W. 96TH ST.
M-91	1615	OCT. 1954	1000 W. 96TH ST. TO 1000 W. 97TH ST.
M-92	1616	OCT. 1954	1000 W. 97TH ST. TO 1000 W. 98TH ST.
M-93	1617	OCT. 1954	1000 W. 98TH ST. TO 1000 W. 99TH ST.
M-94	1618	OCT. 1954	1000 W. 99TH ST. TO 1000 W. 100TH ST.

MAP CHANGES

NO.	ORD.	PASSED	LOCATION
M-101	1619	OCT. 1954	1000 W. 100TH ST. TO 1000 W. 101ST ST.
M-102	1620	OCT. 1954	1000 W. 101ST ST. TO 1000 W. 102ND ST.
M-103	1621	OCT. 1954	1000 W. 102ND ST. TO 1000 W. 103RD ST.
M-104	1622	OCT. 1954	1000 W. 103RD ST. TO 1000 W. 104TH ST.
M-105	1623	OCT. 1954	1000 W. 104TH ST. TO 1000 W. 105TH ST.
M-106	1624	OCT. 1954	1000 W. 105TH ST. TO 1000 W. 106TH ST.
M-107	1625	OCT. 1954	1000 W. 106TH ST. TO 1000 W. 107TH ST.
M-108	1626	OCT. 1954	1000 W. 107TH ST. TO 1000 W. 108TH ST.
M-109	1627	OCT. 1954	1000 W. 108TH ST. TO 1000 W. 109TH ST.
M-110	1628	OCT. 1954	1000 W. 109TH ST. TO 1000 W. 110TH ST.
M-111	1629	OCT. 1954	1000 W. 110TH ST. TO 1000 W. 111TH ST.
M-112	1630	OCT. 1954	1000 W. 111TH ST. TO 1000 W. 112TH ST.
M-113	1631	OCT. 1954	1000 W. 112TH ST. TO 1000 W. 113TH ST.
M-114	1632	OCT. 1954	1000 W. 113TH ST. TO 1000 W. 114TH ST.
M-115	1633	OCT. 1954	1000 W. 114TH ST. TO 1000 W. 115TH ST.
M-116	1634	OCT. 1954	1000 W. 115TH ST. TO 1000 W. 116TH ST.
M-117	1635	OCT. 1954	1000 W. 116TH ST. TO 1000 W. 117TH ST.
M-118	1636	OCT. 1954	1000 W. 117TH ST. TO 1000 W. 118TH ST.
M-119	1637	OCT. 1954	1000 W. 118TH ST. TO 1000 W. 119TH ST.
M-120	1638	OCT. 1954	1000 W. 119TH ST. TO 1000 W. 120TH ST.
M-121	1639	OCT. 1954	1000 W. 120TH ST. TO 1000 W. 121ST ST.
M-122	1640	OCT. 1954	1000 W. 121ST ST. TO 1000 W. 122ND ST.
M-123	1641	OCT. 1954	1000 W. 122ND ST. TO 1000 W. 123RD ST.
M-124	1642	OCT. 1954	1000 W. 123RD ST. TO 1000 W. 124TH ST.
M-125	1643	OCT. 1954	1000 W. 124TH ST. TO 1000 W. 125TH ST.
M-126	1644	OCT. 1954	1000 W. 125TH ST. TO 1000 W. 126TH ST.
M-127	1645	OCT. 1954	1000 W. 126TH ST. TO 1000 W. 127TH ST.
M-128	1646	OCT. 1954	1000 W. 127TH ST. TO 1000 W. 128TH ST.
M-129	1647	OCT. 1954	1000 W. 128TH ST. TO 1000 W. 129TH ST.
M-130	1648	OCT. 1954	1000 W. 129TH ST. TO 1000 W. 130TH ST.
M-131	1649	OCT. 1954	1000 W. 130TH ST. TO 1000 W. 131ST ST.
M-132	1650	OCT. 1954	1000 W. 131ST ST. TO 1000 W. 132ND ST.
M-133	1651	OCT. 1954	1000 W. 132ND ST. TO 1000 W. 133RD ST.
M-134	1652	OCT. 1954	1000 W. 133RD ST. TO 1000 W. 134TH ST.
M-135	1653	OCT. 1954	1000 W. 134TH ST. TO 1000 W. 135TH ST.
M-136	1654	OCT. 1954	1000 W. 135TH ST. TO 1000 W. 136TH ST.
M-137	1655	OCT. 1954	1000 W. 136TH ST. TO 1000 W. 137TH ST.
M-138	1656	OCT. 1954	1000 W. 137TH ST. TO 1000 W. 138TH ST.
M-139	1657	OCT. 1954	1000 W. 138TH ST. TO 1000 W. 139TH ST.
M-140	1658	OCT. 1954	1000 W. 139TH ST. TO 1000 W. 140TH ST.
M-141	1659	OCT. 1954	1000 W. 140TH ST. TO 1000 W. 141ST ST.
M-142	1660	OCT. 1954	1000 W. 141ST ST. TO 1000 W. 142ND ST.
M-143	1661	OCT. 1954	1000 W. 142ND ST. TO 1000 W. 143RD ST.
M-144	1662	OCT. 1954	1000 W. 143RD ST. TO 1000 W. 144TH ST.
M-145	1663	OCT. 1954	1000 W. 144TH ST. TO 1000 W. 145TH ST.
M-146	1664	OCT. 1954	1000 W. 145TH ST. TO 1000 W. 146TH ST.
M-147	1665	OCT. 1954	1000 W. 146TH ST. TO 1000 W. 147TH ST.
M-148	1666	OCT. 1954	1000 W. 147TH ST. TO 1000 W. 148TH ST.
M-149	1667	OCT. 1954	1000 W. 148TH ST. TO 1000 W. 149TH ST.
M-150	1668	OCT. 1954	1000 W. 149TH ST. TO 1000 W. 150TH ST.